



Soyland Town Road, Soyland, HX6 4NB
£160,000

E&H Holmes
ESTATE AGENTS

Situated in the heart of Soyland Village is this three bedroom, mid terrace cottage with detached garage which is in need of a full program of modernisation and renovation. This house offers the ideal opportunity to create a true country home in a stunning rural location.

The accommodation, in brief, comprises: Entrance vestibule, lounge, dining kitchen and bathroom. On the first floor are three bedrooms. Across the road from the property is the detached garage and access to an outbuilding.

EPC - TBC

Council Tax Band - B



Entrance Vestibule

Wooden door to front elevation.

Lounge 13'0" max x 13'10" (3.968 max x 4.223)

Gas fire. Built in cupboards. UPVC double glazed window to front elevation.

Kitchen 8'10" x 8'0" (2.713 x 2.460)

Stainless steel sink. Gas cooker and electric cooker point. UPVC double glazed window to rear elevation.

Bathroom 6'3" x 5'4" (1.929 x 1.637)

Wash hand basin. Low flush W.C. Bath with electric shower over.

Landing

Stairs leading from kitchen.

Bedroom One 10'9" x 12'4" (3.299 x 3.782)

Built in wardrobes. UPVC double glazed window to front elevation.

Bedroom Two 11'10" x 6'4" (3.609 x 1.939)

Loft access. UPVC double glazed window to rear elevation.

Bedroom Three 6'9" x 7'2" (2.069 x 2.209)

Cupboard housing water tank. UPVC double glazed window to rear elevation.

Detached Garage 14'5" x 14'8" (4.408 x 4.475)

Up and over doors. Power. Light. Water. Wooden door to side. Double glazed windows to side.

Yard

Access to a gated yard next to the garage is shared with neighbouring properties. This provides access to an outbuilding and the facility to dry washing.

Council Tax Band B

Location

To find the property, you can download a free app called What3Words which every 3 metre square of the world has been given a unique combination of three words.

The three words designated to this property are:
reclining.drunk.tonight

Disclaimer

DISCLAIMER: Whilst we endeavour to make our sales details accurate and reliable they should not be relied on as statements or representations of fact and do not constitute part of an offer or contract. The Seller does not make or give nor do we or our employees have authority to make or give any representation or warranty in relation to the property. Please contact the office before viewing the property to confirm that the property remains available. This is particularly important if you are contemplating travelling some distance to view the property. If there is any point which is of particular importance to you we will be pleased to check the information for you. We would strongly recommend that all the information which we provide about the property is verified by yourself on inspection and also by your conveyancer, especially where statements have been made to the effect that the information provided has not been verified.

We are not a member of a client money protection scheme.

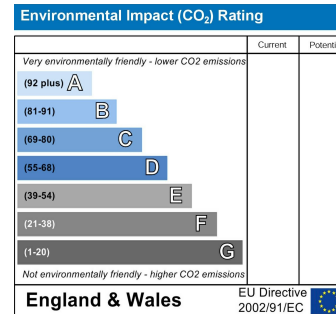
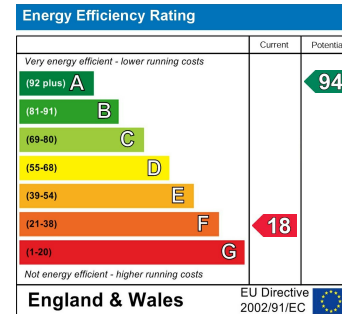





Ground Floor

Approx. 32.0 sq. metres (344.3 sq. feet)



First Floor

Approx. 30.2 sq. metres (325.5 sq. feet)

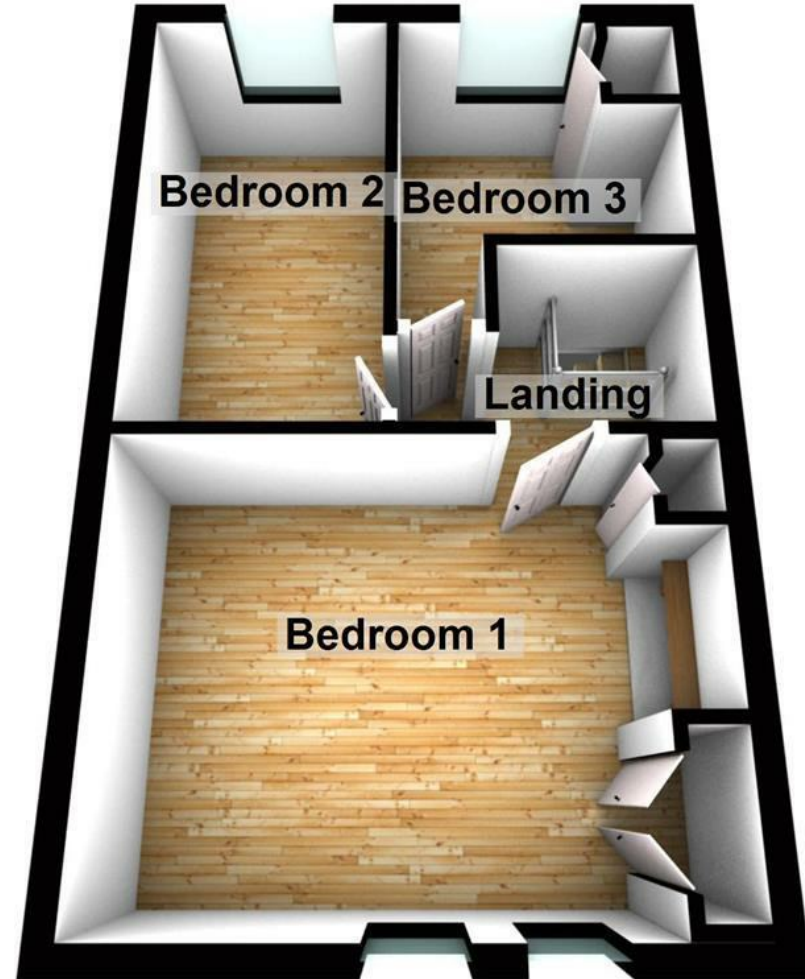

Total area: approx. 62.2 sq. metres (669.8 sq. feet)

This floor plan is intended to give a general indication of the proposed floor layout only. Dimensions should not be used for carpets, flooring, appliance spaces or items of furniture fixed or free standing.

Plan produced using PlanUp.

6a Stainland Rd, West Vale, Halifax, West Yorkshire, HX4 8AD

www.edkinsandholmes.co.uk • 01422 310044